

**SPECIFICATIONS**

1. Rating : DC 30V , 5.0A
2. Contact resistance :  $\leq 30m\Omega$
3. Insulation resistance :  $\geq 100M\Omega$
4. Withstand voltage : 500VAC
5. Insertion and extraction force : 3-20N
6. life test : 5,000 cycles

Model No.	DC-D099-x
SCHEMATIC	
CENTER PIN	$\phi 2.00$ mm
	$\phi 2.50$ mm

NO.	DESCRIPTION	QTY	MATERIAL	PLATING
8	SPLIT WASHER	1	IRON	Ni-Plating
7	NUT	1	BRASS	Ni-Plating
6	COVER	1	PBT	
5	HOUSING	1	PBT (BLACK)	
4	SPRING	1	PHOSPHOR BRONZE	Sn-Plating
3	PIN	1	BRASS	Ni-Plating
2	CONTACT FOOT	1	BRASS	Sn-Plating
1	COAT	1	BRASS	Ni-Plating



**东莞市高迪电子有限公司**  
Dong Guan KDRR Electronic Switch Jack Co., Ltd.

TOLERANCE UNLESS OTHERWISE STATED :

Up to 5  $\pm 0.2$   
Above 5 ~ 15  $\pm 0.3$   
Above 15 ~ 30  $\pm 0.4$   
Above 30 ~ 50  $\pm 0.5$   
Angle  $\pm 0.3^\circ$

3RD. ANGEL'S

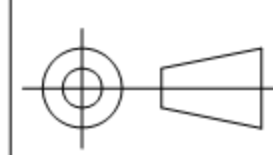

UNITS

MM

DRAWN BY: Jack Lu  
DATE: 07/17/20  
CHECKED BY: Jacky Chen  
DATE: 07/17/20  
APPROVED BY: Tony Kao  
DATE: 07/17/20

MAT'L	TITLE	JACK
FINISH	MODLE	DC JACK
SCALE	DWG NO.	DC-D099-x-S124
SHEET NO.	PART NO.	DC-D099-x-S124

SIZE  
A4  
VER  
R1

ITEM NO.	DESCRIPTION	DRAWN	DATE
1	更新SPEC及MATERIAL	Jack	071720